

The 50th Anniversary of Annual Meeting of the Herpetological Society of Japan

PROGRAM

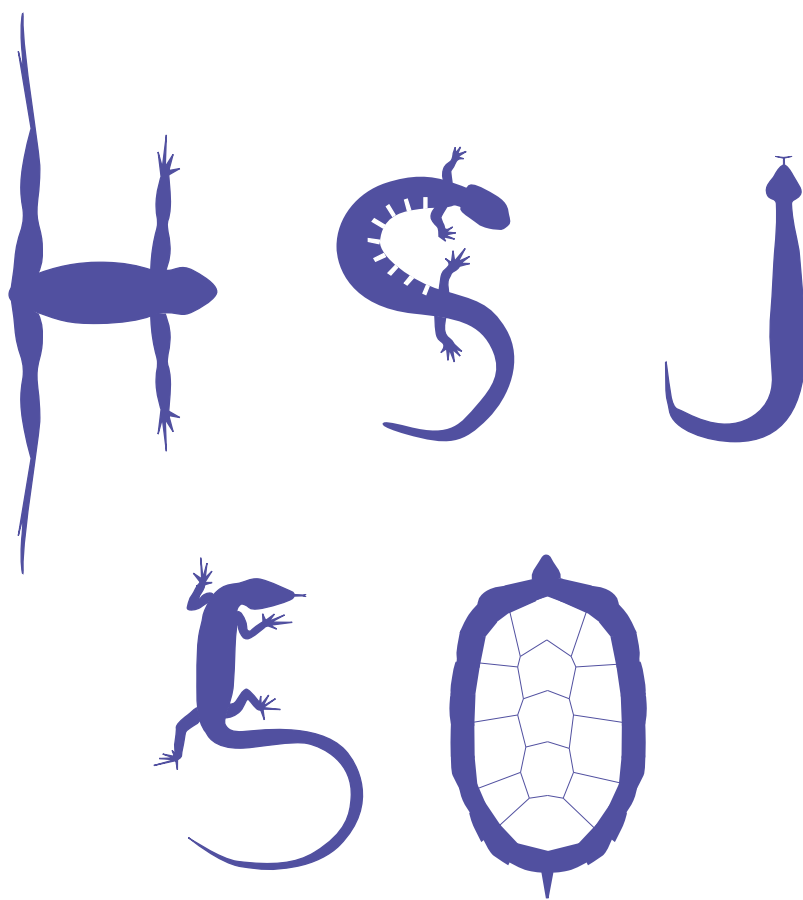

Yoshida Campus, Kyoto University
8–10 October, 2011

The 50th Annual Meeting of Herpetological Society of Japan

Schedule:

2011.10.8 (Sat)		2011.10.9 (Sun)		2011.10.10 (Mon)	
Registration	08:30	Registration	08:30	Registration	08:30
Opening address	09:25	Oral presentations	09:00	Oral presentations	09:00
Oral presentations	09:30	Lunch	12:10	Lunch	12:10
Lunch	12:10	Anniversary Lectures	13:20	Poster presentations	13:20
Poster presentations	13:10	Group photo	14:50	Oral presentations	14:20
Oral presentations	14:30	Business meeting	15:20	Closing address	16:45
Satellite meeting	18:30	Poster presentations	16:20		
		Banquet	18:00–20:30		

Venue: Faculty of Science Bldg. No. 6 and Seminar House, North Campus
Graduate School of Science, Kyoto University,
Kitashirakawa-oiwakecho, Sakyo, Kyoto 606-8502, Japan

Fee: Registration, ¥3,500, banquet, ¥4,500
(registered by 22 July: registration, ¥3,000, banquet, ¥4,000)

Oral presentation:

Each presentation should be made for 12 minutes, and will be followed by 3 minutes of discussion. Files for the presentation should be formatted for the Microsoft PowerPoint 2007 or Adobe (Acrobat) Reader in Windows (7) or Macintosh Mac OS X, and KeyNote in Mac OS X. Please pass your file in CD or USB stick memory to our staff at reception desk.

Poster presentation:

Poster panel size: 90 cm (width) x 210 cm (height). Posters can be set up from 9:00 on 8 October, and should be removed by 17:00 on 10 October by presenters.

Abstracts:

Abstracts of presentations, which will appear in the Bulletin of the Herpetological Society of Japan 2012(1), should be sent to "hsj50@zoo.zool.kyoto-u.ac.jp" by 7 October 2011.

Each abstract should include title, author(s), his/her (their) affiliation(s) and text (less than 200 words).

The Office of the 50th Annual Meeting of the Herpetological Society of Japan
Department of Zoology, Graduate School of Science, Kyoto University, Sakyo, Kyoto, 606-8502, Japan
Tel: +81-75-753-4091 (Hikida), +81-75-753-4075 (Mori)
Fax: +81-75-753-4114
e-mail:hsj@zoo.zool.kyoto-u.ac.jp

Access

From Kyoto Station

Please take Kyoto City Bus (Route 17), or Taxi bound for bus stop, “Kyodai Nogakubu-mae” at the gate of North Campus of Kyoto University. It will take approximately 35 minutes by bus and 20 minutes by Taxi. Route 17 bus starts in the Bus Station in front of JR Kyoto Station.

Meeting Venue: Faculty of Science Building No. 6, North Campus, Kyoto University

Place for Banquet: 2nd Floor of Clock Tower Centennial Hall, Main Campus, Kyoto University

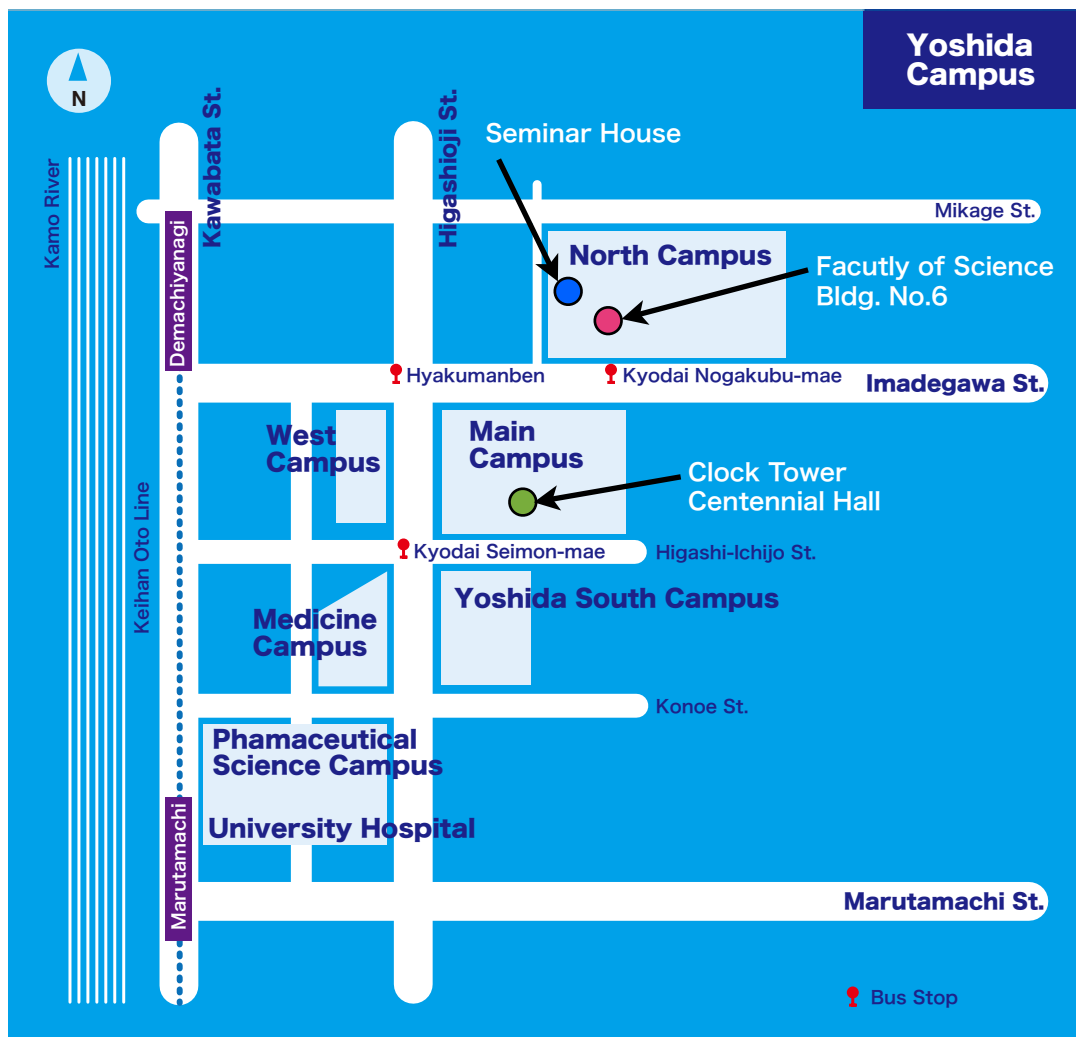

Campus Maps

North Campus

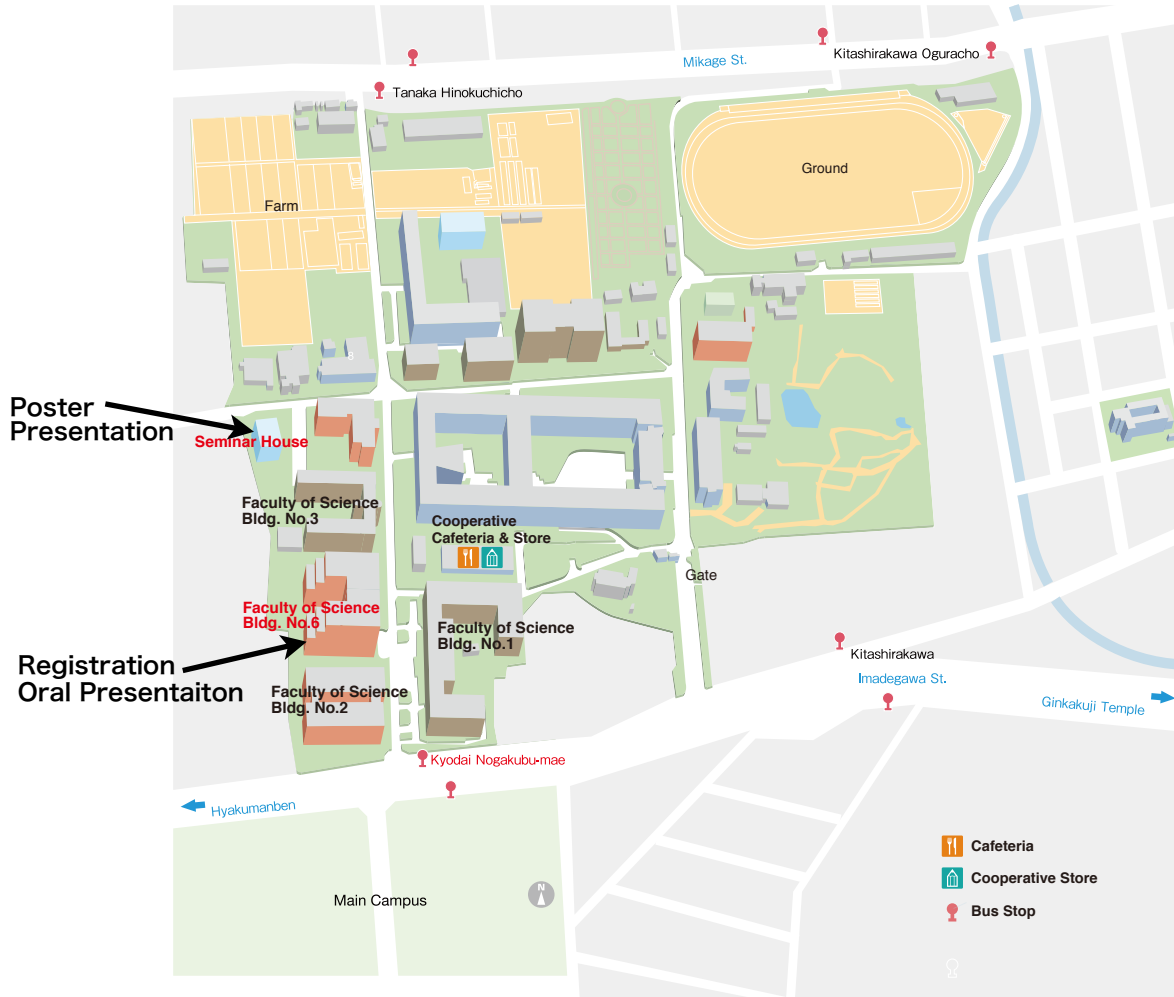

Main Campus



Faculty of Science Bldg. No.6 South Part

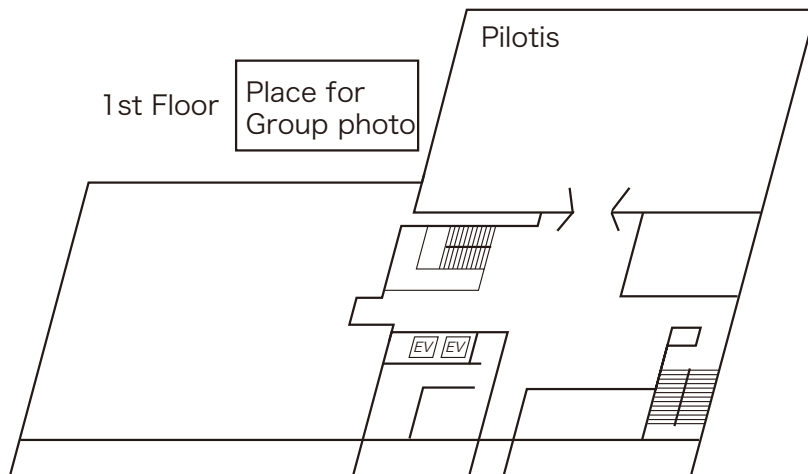
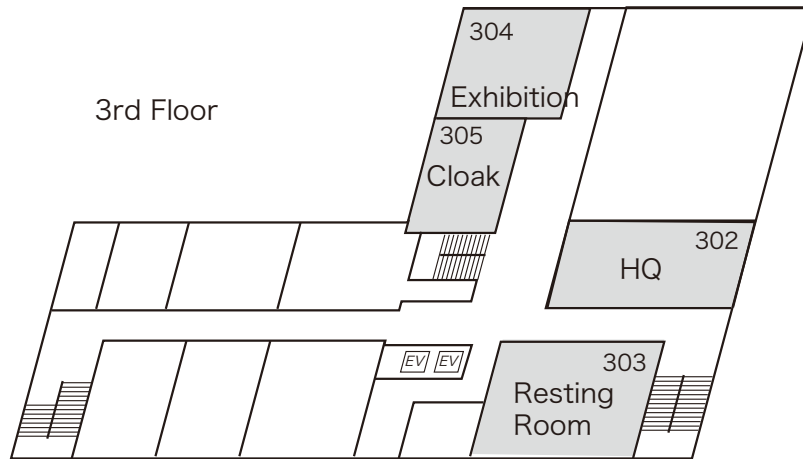
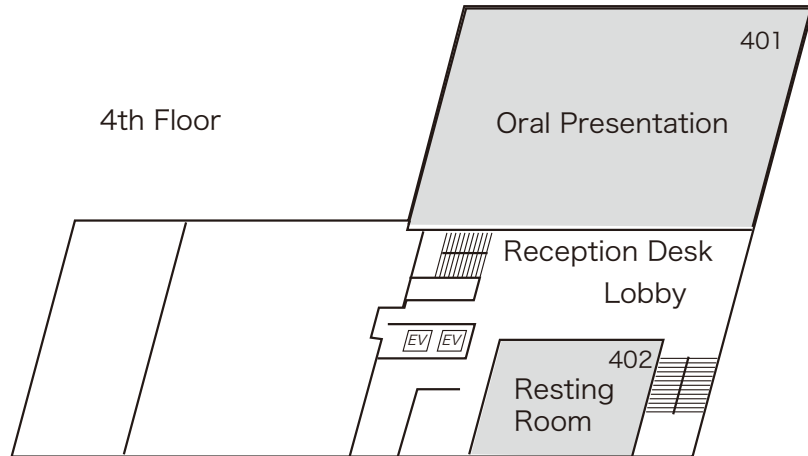

Oral Presentation Saturday, 8th October, 2011 Room 401

(Chair: Masayuki Sumida)

O-01 09:30–09:45
Norihiro Kuraishi & Masafumi Matsui (Grad. Sch. Hum. Env. Stud., Kyoto Univ.)
Intraspecific variation of several *Polypedates* species as revealed by nucleotide sequences of mitochondrial and nuclear DNA

O-02 09:45–10:00
Tatsuhiko Nishimura & Masafumi Matsui (Grad. Sch. Hum. Env. Stud., Kyoto Univ.)
Phylogenetic relationship of the *Limnonectes doriae* group

O-03 10:00–10:15
Amir Hamidy & Masafumi Matsui (Grad. Sch. Hum. Env. Stud., Kyoto Univ.)
Genetic variation in *Leptobrachium nigrops*

O-04 10:15–10:30
Wang Bin, Jiang Jianping & Xie Feng (Chengdu Inst. Biol., Chinese Acad. Sci.)
Systematics and phylogeography of *Feirana* (Dicroglossidae, Anura, Amphibia)

O-05 10:30–10:45
Masafumi Matsui (Grad. Sch. Hum. Env. Stud., Kyoto Univ.)
On *Microhyla borneensis*

10:45–10:55 Break

(Chair: Sen Takenaka)

O-06 10:55–11:10
Hidetoshi Ota (Univ. Hyogo/Mus. Nat. Human Act.), **Masanao Honda** (Grad. Sch. Life Env. Sci., Univ. Tsukuba) & **Truon Quang Ngyuen** (Inst. Ecol. Biol. Res., Vietnam)
Phylogeny of the genus *Goniurosaurus* (Squamata: Eublepharidae)

O-07 11:10–11:25
Takaki Kurita (Grad. Sch. Eng. Sci., Univ. Ryukyus), **Masanao Honda** (Grad. Sch. Life Env. Sci., Univ. Tsukuba) & **Mamoru Toda** (Trop. Biosphere Res. Cent., Univ. Ryukyus)
Population structure of *Goniurosaurus k. kuroiwa*, with special reference to distribution ranges and boundaries among genetic races in Okinawajima Island

O-08 11:25–11:40
Mamoru Toda (Tropical Biosphere Research Center, Univ. Ryukyu)
Taxonomy, phylogeny, and biogeography of the genus *Gekko* in Japan

O-09 11:40–11:55
Yuko Shitomi, Yasuo Ezaki & Hidetoshi Ota (Inst. Nat. Env. Sci., Univ. Hyogo)
Reproduction and dietary habits of *Gekko tawaensis*, a gekkonid species endemic to temperate Japan

O-10 11:55–12:10
Teppeï Jono (Dept. Zool, Grad. Sch. Sci, Kyoto Univ.)
Discerning geckos, undiscerning geckos: Female response toward conspecific and heterospecific male calls in *Gekko* species

12:10–13:10 Lunch

13:10–14:30 Poster Presentation Seminar House

Oral Presentation Saturday, 8th October, 2011 Room 401

(Chair: Kinji Fukuyama)

- O-11 14:30–14:45
Koichi, Goka (NIES), Yumi Une (Azabu Univ.), Atsushi Tominaga (Univ. Ryukyu), Sachiko Moriguchi (NIES), Shintaro Abe (MOE), Jean-Marc Hero (Griffith University) & Alex D. Hyatt (CSIRO)
The past and future of amphibian chytridiomycosis
- O-12 14:45–15:00
Haruki Ueda, Shouta Nakayama, Yusuke Kawai (Dept. Tox, Grad. Sch. Vet, Hokkaido Univ.), Tomoko Tanaka-Ueno (Center for Liberal Arts, Meiji Gakuin Univ.), Yoshinori Ikenaka & Mayumi Ishizuka (Dept. Tox, Grad. Sch. Vet, Hokkaido Univ.)
Comparative analysis of xenobiotic metabolic enzymes between *Cynops pyrrhogaster* and *Xenopus laevis*
- O-13 15:00–15:15
Shoichi Yamada (Grad. Sch. Environ, Hokkaido Univ.) & Takenori Takada (Grad. Sch. Environ, Hokkaido Univ.)
Effect of temperature in habitats and temperature-dependent fitness on sex ratio
- O-14 15:15–15:30
Masahiro Saka & Noriko Tada (Kyoto Pref. Inst. Publ. Health Environ.)
Elemental analysis of commercial diets for amphibians and reptiles
- O-15 15:30–15:45
Nguyen Thien Tao (Vietnam National Museum of Nature, Vietnam)
The amphibian of Vietnam and new discoveries
- O-16 15:45–16:00
Yasuyuki Nakamura (Trop. Biosph. Res. C., Univ. Ryukyus) & Atsuko Miyaji (Grad. Sch. Humanities and Science, Nara Women's Univ.)
Frog remains from a pit (the early Tumulus period) at the Makimuku archeological site, Sakurai City, Nara Prefecture, Japan
- O-17 16:00–16:15
Koji Tanaka (Dept. Zool, Grad. Sch. Sci, Kyoto Univ.)
Study on geographic variation in hatchling size of *Elaphe quadrivirgata* using the allometric engineering: a preliminary report

16:15–16:25 Break

Oral Presentation Saturday, 8th October, 2011 Room 401

(Chair: Takashi Yabe)

- O-18 16:25–16:40
Tsutomu Hikida (Dept. Zool., Grad. Sch. Sci., Kyoto Univ.) & Dai Suzuki (Dept. Marine Sci., TUMSAT)
Linguistic geography of local names of Japanese turtles
- O-19 16:40–16:55
Naoki Kamezaki & Mari Taniguchi (Kobe-Suma Aquarium)
Vertical distribution of fresh water turtles in Japan
- O-20 16:55–17:10
Mari Taniguchi & Naoki Kamezaki (Kobe-Suma Aquarium)
Size and sex ratio of introduced red-eared sliders in Japan
- O-21 17:10–17:25
Misato Takeuchi (Grad. Sch. Human Sci. Env., Univ. Hyogo), Koichi Kawamura (Dept. Bioresources, Mie Univ.), Hong-Shik Oh (Dept. Sci. Ed., Cheju Natl. Univ.) & Hidetoshi Ota (Inst. Nat. Sci., Univ. Hyogo)
Genetic variation and historical biogeography in the *Pelodiscus sinensis* complex in East Asia, as revealed by mitochondrial DNA sequences
- O-22 17:25–17:40
Noriko Tada & Masahiro Saka (Kyoto Pref. Inst. Publ. Health Environ.)
A subadult stage of female *Chinemys reevesii*
- O-23 17:40–17:55
Dai Suzuki (Dept. Marine Sci, TUMSAT), Takashi Yabe (Colleg. Contemp. Manag., Aichi Gakusen Univ.), Tatsuya Noro (Chelonian Japan) & Tsutomu Hikida (Dept. Zool., Grad. Sch. Sci, Kyoto Univ.)
Genetic pollution caused by a non-native freshwater turtle species, *Ocadia sinensis*, in Japan
- O-24 17:55–18:10
Azusa Hayano, Miho Inoue-Murayama (WRC, Kyoto Univ.), Makoto Soichi, Masanori Kurita (Port of Nagoya Public Aquarium), Senzoh Uchida, Hideshi Teruya (Okinawa Churaumi Aquarium) & Naoki Kamezaki (Kobe-Suma Aquarium /Sea Turtle Association of Japan)
Genetic analysis of captive hawksbill sea turtles originated from the wild
- O-25 18:10–18:25
Kei Okamoto (Dept. Ecosystem Stud., Grad. Sch. Agr., Tokyo Univ.) & Naoki Kamezaki (Kobe Suma Aquarium/Dept. Ecosystem Stud., Grad. Sch. Agr., Tokyo Univ.)
The holotype of *Chelonia agassizii* deposited in the collections of the Muséum National d’Histoire Naturelle, Paris

18:30– Satellite Meeting

Oral Presentation Sunday, 9th October Room 401

(Chair: Yasuchika Misawa)

O-26 09:00–09:15

Kanto Nishikawa, Masafumi Matsui (Grad. Sch. Hum. Env. Stud., Kyoto Univ.) & Jian-Ping Jiang (Chengdu Inst. Biol., Chinese Acad. Sci.)

Current taxonomy of a Chinese newt, *Pachytriton*

O-27 09:15–09:30

Hiroataka Sugawara, Takeshi Igawa (Inst. Amphibian Biol., Grad. Sch. Sci., Hiroshima Univ.), Shohei Oumi (Amami City), Seiki Katsuren (Okinawa Pref. Inst. Health and Environment), Masashi Yokogawa, Yuji Isagi (Div. Forest Biomaterials Sci., Grad. Sch. Agri., Kyoto Univ.) & Msayuki Sumida (Inst. Amphibian Biol., Grad. Sch. Sci., Hiroshima Univ.)

Microsatellite DNA analysis of population structure and attempt at captive breeding in an endangered newt, *Echinotriton andersoni*

O-28 09:30–09:45

Mariko Sakamoto (F-trek), Kazuhiro Sakata (West J.E.C.) & Masafumi Matsui (Grad. Sch. Hum. Env. Stud., Kyoto Univ.)

A comparison of age at maturity in three populations of *Hynobius yatsui* from Kyushu

O-29 09:45–10:00

Hiroshi Okawa (Kure city) & Takashi Okuno (Kure-Mitsuta Senior Highschool, Hiroshima Pref.)

Abu Type of *Hynobius nebulosus*

O-30 10:00–10:15

Ami Iwata (Nature and Science Club, Gifu High School), Masaki Takagi (Gifu High School), Kanna Aoyama, Keitaro Umemura, Kaho Ohmae (Nature and Science Club, Gifu High School) & Takahiko Mukai (Fac. Regional Study, Gifu Univ.)

Conservation of *Hynobius nebulosus* in Gifu and analysis of genetic diversity

O-31 10:15–10:30

Takashi Matsuki (Minist. Environ., Japan) & Masafumi Matsui (Grad. Sch. Hum. Env. Stud., Kyoto Univ.)

Reproduction of *Hynobius nebulosus* in an artificial pond in Kyoto, IV.

10:30–10:40 Break

Oral Presentation Sunday, 9th October Room 401

(Chair: Hidetoshi Ota)

- O-32 10:40–10:55
Akira Mori & Teppei Jono (Dept. Zool., Grad. Sch. Sci., Kyoto Univ.)
Defensive reaction to a snake predator and its eye by a Madagascan chameleon
- O-33 10:55–11:10
Daisuke Suzuki (Dept. Anat, Sapporo Med. Univ., Sch Med.)
Jaw mechanics of crocodiles reveals their fast mastication
- O-34 11:10–11:25
Taku Okamoto (Natl. Inst. Environ. Studies), **Takeo Kuriyama** (Fac. Sci., Toho Univ.), & **Koichi Goka** (Natl. Inst. Environ. Studies)
Risk assessment of extinction of *Plestiodon latiscutatus* (Scincidae, Squamata) population on Hachijojima Island, the Izu Islands, central Japan, by introgressive hybridization with non-native *P. japonicus* population
- O-35 11:25–11:40
Sen Takenaka (Tokai Univ., Sch. Biol. Tech.)
Unsuccessfully developed embryos found in reproduction of the viviparous lizard, *Zootoca vivipara*
- O-36 11:40–11:55
Noriko Kidera (Life Sci. NTNU), **Ming-Chung Tu** (Life Sci. NTNU) & **Akira Mori** (Dept. Zool, Grad. Sch. Sci, Kyoto Univ.)
Discrimination of water salinity in three species of the genus *Laticauda*
- O-37 11:55–12:10
Takeo Kuriyama (Toho Univ.), **Hanae Misawa** (Narita HS) & **Naoko Ozawa** (Toho Univ.)
Pigment cells producing color variations in Japanese four-lined snakes, *Elaphe quadrivirgata*

12:10–13:20 Break

13:20–14:50 The 50th Anniversary Lectures Room 401

Koji Hara **Memory of the Herpetological Society of Japan**

Masafumi Matsui **History of the Herpetological Society of Japan**

14:50–15:20 Group Photo

15:20–16:20 Bussiness Meeting Room 401

16:20–17:45 Poster Presentation Seminar House

18:00–20:30 Banquet Centennial Clock Tower International Hall, Main Campus

Oral Presentation Monday, 10th October Room 401

(Chair: Mitsuhiro Toda)

- O-38 09:00–09:15
Kinji Fukuyama (Dept. Biol., Keio Univ.)
Monitoring of breeding *Odorrana supranarina* by time-lapse video camera
- O-39 09:15–09:30
Tomohiko Shimada & Juntaro Kato (Dept. Sci. Edu, Fac. Edu, Aichi Univ. Edu.)
Species identification of frogs in the Japanese paddy field by flow cytometry
- O-40 09:30–09:45
Takanori Sato (Tenri Univ.) & Shigehiro Nakabayashi (Hokkaido Lab. Herpetol.)
Overwintering sites of a brown frog, *Rana pirica*, inhabiting in Kushiro Marsh, Hokkaido
- O-41 09:45–10:00
Yuri Yoshimura (Dept. Biol., Grad. Sch. Systems Life Sci., Kyushu Univ.), Shinji Toyoda (Dept. Animal and Marine Bioresource Sci., Fac. Agri., Kyushu Univ.) & Eiiti Kasuya (Dept. Biol., Fac. Sci., Kyushu Univ.)
The anti-predator defenses of wrinkled frogs (*Rana rugosa*)—The olfactory effects of their skin secretions
- O-42 10:00–10:15
Nozomi Nishiumi & Akira Mori (Dept. Zool., Grad. Sch. Sci., Kyoto Univ.)
Function of immobility in frogs as anti-predator strategy
- O-43 10:15–10:30
Mitsuaki Ogata (Preservation and Research Center, City of Yokohama), Kunio Sekiya (Niigata Univ.), Yoshinori Hasegawa (Kazusa DNA Res. Inst.), Hiromi Ohotani (Inst. Amphibian Biol., Grad. Sch. Sci., Hiroshima Univ.) & Ikuo Miura (Inst. Amphibian Biol., Grad. Sch. Sci., Hiroshima Univ.)
On the advertisement call of the frog *Rana rugosa* from Sado Island
- 10:30–10:40 Break
- (Chair: Tomohiko Shimada)
- O-44 10:40–10:55
Yusuke Mizuno & Masafumi Matsui (Grad. Sch. Hum. Env. Stud., Kyoto Univ.)
A phylogenetic study of *Rhacophorus arboreus*
- O-45 10:55–11:10
Koshiro Eto, Masafumi Matsui (Grad. Sch. Hum. Env. Stud., Kyoto Univ.) & Yasuchika Misawa (Civil Eng. Eco-Technol. Conslt.)
On two types of *Rana tagoi tagoi* from former Kuni-mura, Gunma Prefecture
- O-46 11:10–11:25
Ikuo Miura (Amphibian Biol. Inst., Grad. Sch. Sci, Hiroshima Univ.), Gakuto Watanuki, Youko Ichikawa (Pref. Univ. Hiroshima, Fac. Life Environ. Sci., Dept. Environ. Sci) & Hiroyuki Fujita (Saitama Museum Rivers)
Sex chromosomes of the stream brown frog *Rana sakuraii*
- O-47 11:25–11:40
Sanghoon Han, Jumin Jun (NIBR Korea) & Hyuntae Kim (Seosan High School)
Revision on phylogenetic status of some species of genus *Rana* (Anura) in Northeast Asia

Oral Presentation Monday, 10th October Room 401

(Chair: Tomohiko Shimada)

O-48 11:40–11:55

Takeshi Igawa (Inst. Amphibian Biol., Grad. Sch. Sci., Hiroshima Univ.), Shohei Oumi (Amami City), Seiki Katsuren (Okinawa Pref. Inst. Health Environ.) & Masayuki Sumida (Inst. Amphibian Biol., Grad. Sch. Sci., Hiroshima Univ.)

Population structures and its causal landscapes of two endangered frog species of genus *Odorrana*

O-49 11:55–12:10

Ryosuke Kakehashi, Atsushi Kurabayashi (Inst. Amphibian Biol., Grad. Sch. Sci., Hiroshima Univ.), Shohei Oumi (Amami City), Seiki Katsuren (Okinawa Pref. Inst. Health and Environment), Masaki Hosono (NCB Naturalis) & Masayuki Sumida (Inst. Amphibian Biol., Grad. Sch. Sci., Hiroshima Univ.)

Phylogenetic position of the genus *Babina* based on mt genomic information

12:10–13:20 Lunch

13:20–14:20 Poster Presentation Seminar House

(Chair: Mamoru Toda)

O-50 14:20–14:35

Hirohiko Takeuchi (Dept. Zool. Grad. Sch. Sci., Kyoto Univ.), Masafumi Matsui (Grad. Sch. Hum. Env. Stud., Kyoto Univ.) & Tsutomu Hikida (Dept. Zool. Grad. Sch. Sci., Kyoto Univ.)

Phylogeography of *Achalinus spinalis* (Serpentes, Xenodermatidae) in the Japanese main islands

O-51 14:35–14:50

Kazuki Kojima (Coll. Biol. Sci., Univ. Tsukuba), Masanao Honda (Grad. Sch. Life Environ. Sci., Univ. Tsukuba), Isao Takiguchi (Grad. Sch. Engin. Sci., Univ. Ryukyus) & Hidetoshi Ota (Inst. Nat. Environ. Sci. Mus. Nat. Hum. Activ., Univ. Hyogo)

Genetic differentiation of *Dinodon semicarinatum* (Squamata, Colubridae) inferred from mitochondrial DNA

O-52 14:50–15:05

Takuma Kaito (Grad. Sch. Eng. Sci., Univ. Ryukyus) & Mamoru Toda (Tropical Biosphere Research Center, Univ. Ryukyus)

Genetic variation among island populations of the Pryer's keelback snake, *Amphiesma pryeri*

O-53 15:05–15:20

Nontivich Tandavanitj (Grad. Sch. Engin. Sci., Univ. Ryukyus), Hidetoshi Ota (Inst. Nat. Environ. Sci. Mus. Nat. Hum. Activ., Univ. Hyogo) & Mamoru Toda (Tropic. Biosph. Res. Center, Univ. Ryukyus)

Taxonomic status of two hydrophiine sea snakes, *Hydrophis melanocephalus* and *H. cyanocinctus*, in the Ryukyu Archipelago: a molecular reassessment

15:20–15:30 Break

Oral Presentation Monday, 10th October Room 401

(Chair: Atsushi Tominaga)

O-54 15:30–15:45

Madoka Kitajima, Toshishige Itoh & Ikuo Ueda (Enoshima Aquarium)

First record of the *Fejervarya limnocharis* from Enoshima island beachside, Kanagawa

O-55 15:45–16:00

Nozomi Shintani (Inst. Amphibia Biol., Grad. Sch. Sci., Hiroshima Univ.), Masaki Shimamura (Dept. Biol., Grad. Sch. Sci., Hiroshima Univ.), Seiki Katsuren (Okinawa Pref. Inst. Health Environ.), Atsushi Kurabayashi & Masayuki Sumida (Inst. Amphibia Biol., Grad. Sch. Sci., Hiroshima Univ.)

Observation of dermal chromatophore unit structure in the blue variant of *Odorrana ishikawae*

O-56 16:00–16:15

Sumio Okada (Grad. Sch. Eng., Tottori Univ.), Yukihiro Fukuda, Etsuko Yuki (Top Out Images) & Tamami Okada (Mt. Hyonosen Hibikinomori Museum)

Field observations of parental care of egg masses by male Japanese giant salamanders, *Andrias japonicus*

O-57 16:15–16:30

Natsuhiko Yoshikawa, Masafumi Matsui & Kanto Nishikawa (Grad. Sch. Hum. Env. Stud., Kyoto Univ.)

Current status of the introduced Chinese giant salamander in Kamo River, Kyoto-III

16:30–16:40 Closing Address

Poster Presentation Seminar House
8th (Sat)–10th (Mon) October 2011

- P-01 **Yuki Ouchi** (Dept. Ecosystem Stud., Grad. Sch. Agr., Tokyo Univ.) & Naoki Kamezaki (Kobe-Suma Aquarium/Dept. Ecosystem Stud., Grad. Sch. Agr., Tokyo Univ.)
Analysis of nesting locomotion of loggerhead turtle (*Caretta caretta*)
- P-02 **Takahiro Shimada** (Dept. Ecosystem Stud., Grad. Sch. Agr., Tokyo Univ.), Kazunari Kameda, Rihito Kawai, Daichi Oshima (Sea Turtle Asso. Jpn.), Shigeru Aoki (Dept. Ecosystem Stud., Tokyo Univ.) & Naoki Kamezaki (Kobe Suma Aquarium/Dept. Ecosystem Stud., Grad. Sch. Agr., Tokyo Univ.)
Foraging ecology of green turtles *Chelonia mydas* indicated by stable isotopes
- P-03 **Tomoko Hamabata** (Dept. Zool., Grad. Sch. Sci, Kyoto Univ.), Naoki Kamezaki (Kobe-Suma Aquarium/Dept. Ecosystem Stud., Grad. Sch. Agr., Tokyo Univ.) & Tsutomu Hikida (Dept. Zool., Grad. Sch. Sci, Kyoto Univ.)
Genetic structure of green turtle (*Chelonia mydas*) nesting in Japan
- P-04 **Akio Takahashi** (Fac. Inform. Okayama Univ. Sci.), Kimihiko Ōki (Kagoshima Univ. Mus.), Takahiro Ishido, Yukino Kowaki (Minamitane Board of Edu.) & Ren Hirayama (SILS, Waseda Univ.)
Taxonomic notes on a geoemydid (genus *Ocadia*) and a trionychid turtles from the Miocene of Tanegashima Island, Kagoshima Prefecture, Japan
- P-05 **Daiichi Ogano** (Ichihara. High. Sch.)
Records of hybrid turtles between *Mauremys japonica* and *Chinemys reevesii* in Boso Peninsula
- P-06 **Tomoko Nishibori** (Wagame.) & Takashi Yabe (Colleg. Contemp. Manag., Aichi Gakusen Univ.)
Seasonal movement of *Mauremys japonica* and *Chinemys reevesii* in the Taisho River
- P-07 **Jae-Young Song**, Min-Ho Chang, Seon-Du Kim, Jong-Bae Park (Korea National Park Service), Kyo-Soung Koo (Kyounggi Univ.), Seok-Woo Lee (Korea National Park Service), Dong-Gil Cho, Su-Ryeon Kim, Ji-Hyun Lee (NEXUS Environmental Design Center), Sang-Hoon Han (National Institute of Biological Resources)
Home range of Chinese freshwater turtle, *Chinemys reevesii* in Korea
- P-08 **Shigeharu Akiyama** (Seishin Girls'High School)
Behavior of red-eared sliders living in semi-urbanized paddy field areas
- P-09 **Satoshi Kusuda**, Akiko Yoshikawa, Syuhei Asaka, Kumi Haraguchi (Fac. Appl. Biol. Sci., Gifu Univ.) & Takashi Yabe (Colleg. Contemp. Manag., Aichi Gakusen Univ.)
Species composition and sex ratio of the fresh water turtles and evidences of wild breeding of *Trachemys scripta elegans* in the Yanagido, Gifu
- P-10 **Kanako Mine**, Mari Taniguchi & Naoki Kamezaki (Kobe-Suma Aquarium)
Seasonal change of gonad weight in introduced *Trachemys scripta elegans* to Japan
- P-11 **Akiko Yoshikawa**, Satoshi Kusuda, Syuhei Asaka & Osamu Doi (Fac. Appl. Biol. Sci., Gifu Univ.)
Changes in circulating gonadal hormones and blood biochemical parameters associated with egg formation in *Trachemys scripta elegans* living in the Yanagido, Gifu
- P-12 **Takashi Yabe**, Toshihito Miwa & Takashi Niwa (Colleg. Contemp. Manag., Aichi Gakusen Univ.)
Fauna of the freshwater turtles and the rapid increase of the invasive *Trachemys scripta elegans* in the Yamayoke basin, southern Gifu Prefecture, central Japan

- P-13 **Makio Tempaku** (Grad. Bioresource Sci., Nihon Univ.), Satoshi Osawa & Takehiko Katsuno (Coll. Bioresource Sci., Nihon Univ)
Food habit of snapping turtles in east part of Kanagawa Prefecture
- P-14 **Soh Kobayashi**, Seiya Abe & Rikyu Matsuki (CRIEPI-Bio)
Estimation of gene flow from SSR marker of Japanese brown frog (*Rana japonica*) in west side of Inba Lake
- P-15 **Norio Maeda** (JPS) & Kinji Fukuyama (Lab. Biol., Keio Univ.)
Observations of the changing egg mass diameter from spawn to hatch in *Rana ornativentris*
- P-16 **Noe Matsushima** (Tohoku Univ.), Mayo Takayanagi (Ueno Zoo), Takashi Makino & Masakado Kawata (Tohoku Univ.)
Comparison of population structure between two brown frogs inhabiting paddy fields
- P-17 **Dai Togane** (Jpn. Wildl. Res. Center) & Kinji Fukuyama (Lab. Biol., Keio Univ.)
The effectiveness of age determination by skeletochronology of *Rana okinavana* and *Fejervarya sakishimensis* in Iriomote-jima Island
- P-18 **Ai Yagi** (Animal Applied Sci, Grad. Sch. Vet, Azabu Univ.), Kinji Fukuyama (Lab. Biol., Keio Univ.), Dai Togane (Japan Wildlife Research Center) & Seiki Takatuki (Animal Applied Sci, Azabu Univ.)
A comparison of the food habits of two frogs at a paddy field in Machida City, Tokyo, Japan: *Rana japonica* and *Rana porosa porosa*
- P-19 **Koichi Kida** (Grad. Sch. Agri., Shinshu Univ.), Kumiko Okubo (Fac. Agri., Shinshu Univ), Keiichiro Shikata (Iida City Mus) & Yoshitaka Oishi (Fac. Agri., Shinshu Univ.)
Relationships between food habits of *Rana porosa brevipoda* and environmental condition in Ina Basin
- P-20 **Yukari Nagai** (Amphibian Biol. Inst., Hiroshima Univ.), Toshio Doi (Environmental Assessment and Symbiosis Promotion Div., Kobe City Office), Yoshiaki Yuasa (Himeji City Aqua.), Takeshi Fujitani (Higashiyama Zoo Park), Kunio Itou (Kawasaki Senior High Sch. Attached to Kawasaki Medical Sch.), Yuki Koizumi & Ikuo Miura (Amphibian Biol. Inst., Hiroshima Univ.)
Genetic differentiation of the Nagoya daruma frog *Rana porosa brevipoda* II. The geographic populations around boundary area between the two main groups, Okayama and Nagoya
- P-21 **Toshio Doi** (Kobe City)
Status of the daruma pond frog in western Kobe
- P-22 **Noriko Iwai** (NIES)
Home range of Otton frog
- P-23 **Karlina Indraswari**, Ryo Yoneshima & Koji Nakamura (Grad. Sch. Natural Sci. Tech., Kanazawa Univ.)
Abundance and activities of *Rhacophorus arboreus* in satoyama restoration area in Kakuma, Kanazawa
- P-24 **Mitsuhiko Toda** (Japan Wildlife Research Center)
Population structure of the treefrog *Rhacophorus arboreus* on the Kanazawa Castle

- P-25 **Munetaka Nakagawa**, Yasushi Takeuchi, Naoyuki Mizuno & Shigeyuki Nishimori (Society of Environmental Biology)
Distribution of frogs in Minami Yamashiro area in the southern Kyoto Prefecture
- P-26 **Yasuhito Yamamoto** & Yutaro Senga (Grad. Sch. Agri., Tokyo Univ. of Agri. and Tech.)
Sound monitoring of anuran amphibians in two sites of different land use: The frog fauna in East Mikawa area
- P-27 **Daisuke Fukuda**, Takashi Torii, Haruo Hiranaka, Hiroyuki Nishida, Yasuhiro Nagai, Atsushi Abe Satoshi Tateno, Takumi Tsuchida (IDEA Consultants, Inc.) & North Dam Construction Office, Okinawa General Bureau, Cabinet Office
The effectiveness of automatic voice recording of amphibians and birds: As a tool for long-term environment monitoring of a dam
- P-28 **Satoshi Osawa** (Coll. Bioresource Sci., Nihon Univ.)
The impact of tsunami to frogs in Sendai plains
- P-29 **Hae-Jun Baek**, Aram Jeong (Consev. Genome Resouce Bank Korean Wildlife, Res. Vet. Sci. Coll. Vet. Med., Seoul National Univ.), Hyo-Jin Yang (Seoul Grand Park), Hang Lee & Mi-Sook Min (Consev. Genome Resouce Bank Korean Wildlife, Res. Vet. Sci. Coll. Vet. Med., Seoul National Univ.)
Chytridiomycosis pathogen survey in wild population of Korean amphibian
- P-30 Djong Hon Tjong (Fac. Sci., Andalas Univ.), Masafumi Matsui (Grad. Sch. Hum. Env. Stud., Kyoto Univ.), Mitsuru Kuramoto (Munakata City), Midori Nishioka & **Masayuki Sumida** (Inst. Amphibia Biol., Grad. Sch. Sci., Hiroshima Univ.)
A new species of the *Fejervarya limnocharis* complex from Japan (Anura, Dicroglossidae)
- P-31 **Atsushi Kurabayashi** (Inst. Amphibian Res., Grad. Sch. Sci., Hiroshima Univ.), Masafumi Matsui, Amir Hamidy (Grad. Sch. Hum. Env. Stud., Kyoto Univ.), Daicus M. Belabut (Inst. Biol. Sci., Fac. Sci., Univ. Malaya), Mitsuru Kuramoto (Munakata City) & Masayuki Sumida (Inst. Amphibian Res., Grad. Sch. Sci., Hiroshima Univ.)
From Antarctica or Asia? New colonization scenario for Oceanian narrow mouth toads (Asterophryinae) suggested from the findings on a mysterious genus *Gastrophrynoides*
- P-32 **Dong-Youn Kim**, Hae-Jjun Baek, Hang Lee & Mi-Sook Min (CGRB Res. Inst. Vet. Sci. Coll. Vet. Med., Seoul National Univ.)
Genetic variation of Korean wrinkled frogs
- P-33 **Masanao Honda** (Grad. Sch. Life Environ. Sci., Univ. Tsukuba), Takaki Kurita (Grad. Sch. Engin. Sci., Univ. Ryukyus), Mamoru Toda (Tropic. Biosph. Res. Center, Univ. Ryukyus) & Hidetoshi Ota (Inst. Nat. Environ. Sci. Mus. Nat. Hum. Activ., Univ. Hyogo)
Genetic variation among subspecies of *Goniurosaurus kuroiwae* (Squamata, Eublepharidae)
- P-34 **Nobuto Kikukawa** & Tsutomu Hikida (Dept. Zool., Grad. Sch. Sci., Kyoto Univ.)
Geographic variation in skull morphology of the Japanese grass lizard, *Takydromus tachydromoides* (Reptilia: Lacertidae)
- P-35 **Yuki Koizumi** & Tsutomu Hikida (Dept. Zool., Grad. Sch. Sci., Kyoto Univ.)
Genetic variation of *Scincella vandenburghi* (Squamata: Scincidae) based on mitochondrial DNA
- P-36 **Takanori Matsuo** (Nishisonogi-gun, Nagasaki Pref.)
Distribution of the genus *Gekko* in Nagasaki Prefecture

- P-37 **Tatsuya Hara** (Hiroshima Environment & Health Association)
Growth and longevity of *Gekko tawaensis* using long-term mark-recapture data in Hiroshima Prefecture, Japan
- P-38 **Yuko Tawa** (WRC, Kyoto Univ.) & Hideharu Numata (Dept. Zool., Grad. Sch. Sci., Kyoto Univ.)
Circadian and temperature effects on activities in *Gekko japonicus*
- P-39 **Takahide Sasai** (Grad. Sch. Eng. Sci., Univ. Ryukyus), Hiroko Nishioka (Fac. Sci., Univ. Ryukyus), Masako Izawa (Fac. Sci., Univ. Ryukyus) & Mamoru Toda (Trop. Biosphere. Res. Cent., Univ. Ryukyus)
A study on body temperature of *Plestiodon kishinouyei* by use of infrared thermography
- P-40 **Hiroo Takahashi**, Mitsuhiko Toda (Jpn. Wildl. Res. Cent.) & Mamoru Toda (Trop. Biosphere Res. Cent., Univ. Ryukyus)
Current status of introduced population of *Anolis carolinensis* in an urban area of Okinawajima Island
- P-41 **Ryo Ito** (WRC, Kyoto Univ.) & Akira Mori (Dept. Zool, Grad. Sch. Sci, Kyoto Univ.)
Eavesdropping on heterospecific alarm calls by non-vocal Malagasy lizards
- P-42 **Tomomi Takechi**, Masahiro Yasuda, Tetuo Nasu (Dept. Veterinary Science, Miyazaki Univ.), Tetuo Morita (Dept. Plant and Animal Sciences, Miyazaki Univ.), Toshitaka Iwamoto (Dept. Biology, Miyazaki Univ.), Kazuyuki Taniguchi & Nobuaki Nakamuta (Dept. Veterinary Science, Iwate Univ.)
Morphological and histochemical study of the vomeronasal organ in lizard, *Japalura polygonata polygonata*
- P-43 **Takushi Kishida** (Dept. Zool., Grad. Sch. Sci., Kyoto Univ.)
Evolutionary analyses on the sense receptor gene repertoires in squamates
- P-44 **Yosuke Kojima** & Akira Mori (Dept. Zool., Grad. Sch. Sci, Kyoto Univ.)
Do dams of Japanese water snakes (*Rhabdophis tigrinus*) selectively forage for toads?
- P-45 **Min-Ho Chang** (Jeju National Univ.), Byoung-Soo Kim, Tae-Wook Kim, Su-Gon Park & Hong-Shik Oh (National Park Res. Inst.)
Food habit of collared many-toothed snake *Sybynophis chinensis* in Korea
- P-46 **Yohei Kadota** & Akira Mori (Dept. Zool., Grad. Sch. Sci., Kyoto Univ.)
One day to hatch through calcium-poor eggshells in a pit-viper, *Ovophis okinavensis*
- P-47 **Tomohiro Okudaira** & Yoshihisa Mori (Div. Anim. Sci., Teikyo Univ. Sci.)
How do injured Japanese fire-bellied newts move?
- P-48 **Atsushi Tominaga** (Fac. Edu., Univ. Ryukyus), Masafumi Matsui, Natsuhiko Yoshikawa, Kanto Nishikawa (Grad. Sch. Hum. Env. Stud., Kyoto Univ.) & Terutake Hayashi (Tochigi Pref. Mus.)
Genetic groups of *Cynops pyrrhogaster* and their distribution
- P-49 **Masataka Tagami**, Shunsuke Horie & Chikako Horie (Gifu World Freshwater Aquarium)
Captive breeding of *Hynobius yatsui*
- P-50 **Masafumi Yamagami** (TOTO·PLANNING Co., Ltd)
The food habit of larval salamander, *Hynobius yatsui* that lives in underground water

- P-51 **Yasuchika Misawa** (Civil Eng. Eco-Technol. Conslt.) & Masafumi Matsui (Grad. Sch. Hum. Env. Stud., Kyoto Univ.)
Individual distinction of *Hynobius kimurae* larvae based on natural variation in dorsal skin patterns
- P-52 **Hiroshi Ota** (Dept. Environ. Life Sci., Grad. Sch. Life. Sci., Tohoku Univ.)
Tracing terrestrial movement of *Hynobius lichenatus* with radio-telemetry IV
- P-53 **Gen Aoki**, Masafumi Matsui & Kanto Nishikawa (Grad. Sch. Hum. & Env. Stud., Kyoto Univ.)
Genetic variation in the Tohoku salamander, *Hynobius lichenatus*
- P-54 **Hiroyuki Fujita** & Katsuhiko Ishii (Saitama Museum of River)
An example of habitat conservation for *Hynobius tokyoensis* in Yorii town, Saitama Prefecture, Japan
- P-55 **Naoki Mito**, Kazuhiko Ohshima & Osamu Saitoh (Dept. Bio-Sci., Nagahama Inst. Bio-Sci. Tech.)
Ecological and phylogenetic character of the Nagahama population of *Hynobius nebulosus* II
- P-56 **Takayuki Iwata** (Yasugi City Office) & Hiroshi Okawa (Kure City)
Morphological and ecological differences between two groups of *Hynobius nebulosus* in Yasugi-shi, Shimane Prefecture, Japan
- P-57 **Masaichi Kakegawa** (Mitaka High Sch.) & Fujio Kishi (Shirouma Assoc. Nature)
External morphology on breeding season in salamander, *Hynobius hidamontanus* from northern Hakuba area, Ngano Prefecture, Japan
- P-58 **Ayano Omura** (Dept. Glob. Agri. Sci., Grad. Sch. Agri. Sci., Tokyo Univ.) & Hideki Endo (The University Museum, Tokyo Univ.)
Functional-morphological variations of trunk structure of urodela
- P-59 **Sigeharu Terui**, Jun Maeda (Environment grasp promotion network) & Takanori Sato (Dept. Oyasato, Tenri Univ.)
Activity of Siberian salamander (*Salamandrella keyserlingii*) at Mino Area in Kushiro Marsh, Hokkaido

Participant List (persons with * joining Banquet)

Akimichi, Yuuma*
Akita, Yoshinori*
Akiyama, Shigeharu* P-08
Aoki, Gen* P-53
Aoki, Ryosuke*
Arao, Tomoya
Atobe, Takashi
Baek, Hae-Jun* P-29
Chang, Joann C. W.*
Chang, Min-Ho* P-45
Doi, Toshio* P-21
Endo, Satoko*
Eto, Koshiro* O-45
Fujita, Hiroyuki* P-54
Fujitani, Takeshi
Fukuda, Daisuke* P-27
Fukumoto, Yukio*
Fukushima, Masumi
Fukuyama, Kinji* O-38
Goka, Koichi* O-11
Goto, Yasuhito*
Hamabata, Tomoko* P-03
Hamidy, Amir* O-03
Han, Sang-Hoon* O-47
Hara, Koji*
Hara, Tatsuya* P-37
Hasegawa, Iwao*
Hayano, Azusa* O-24
Hayashi, Terutake*
Hikida, Tsutomu* O-18
Hirose, Ayao*
Honda, Masanao* P-33
Igawa, Takeshi* O-48
Indraswari, Karina* P-23
Ito, Ryo* P-41
Iwai, Noriko P-22
Iwata, Ami* O-30
Iwata, Takayuki* P-56
Jono, Teppei* O-10
Kadota, Youhei* P-46
Kaichi, Hiroyuki*
Kaito, Takuma* O-52
Kakegawa, Masaichi* P-57
Kakehashi, Ryosuke* O-49
Kamezaki, Naoki* O-19
Kamidaki, Nanami
Kanai, Kenichiro*
Kanno, Kazuki*
Kawahara, Yasuhiro*
Kawauchi, Kazunori*
Kida, Koichi P-19
Kidera, Noriko* O-36
Kikukawa, Nobuto* P-34
Kim, Dong-Young* P-32
Kimura, Yuki*
Kishida, Takushi* P-43
Kitajima, Madoka* O-54
Kobayashi, Soh* P-14
Koiwa, Satoru*
Koizumi, Yuki* P-35
Koizumi, Yuki*
Kojima, Kazuki* O-51
Kojima, Yosuke* P-44
Kondoh, Megumi*
Korsos, Zoltán*
Kurabayashi, Atsushi* P-31
Kuraishi, Norihiro* O-01
Kurita, Takaki* O-07
Kuriyama, Takeo* O-37
Kusuda, Satoshi P-09
Maeda, Norio* P-15
Maruyama, Kazuko*
Maso, Sachiko*
Matsui, Masafumi* O-05
Matsuki, Takashi* O-31
Matsuo, Kiminori* P-36
Matsushima, Noe* P-16
Min, Mi-Sook*
Mine, Kanako* P-10
Misawa, Yasuchika* P-51
Mito, Naoki P-55
Mitsuoka (Tanimura), Kanako
Miura, Ikuo* O-46
Mizuno, Yusuke* O-44
Mori, Akira* O-32
Moriguchi, Hajime*
Morita, Etsuo*
Motokawa, Masaharu*
Nagai, Yukari* P-20
Nakagawa, Munetaka* P-25
Nakamura, Yasuyuki O-16
Nakazawa, Ryuta*
Nguyen, Tien Tao* O-15
Nishibori, Tomoko* P-06
Nishikawa, Kanto* O-26
Nishimura, Tatsuhiko* O-02
Nishiumi, Nozomi* O-42
Ogano, Dai-ichi* P-05
Ogata, Mitsuaki O-43
Okada, Sumio* O-56
Okamoto, Kei* O-25
Okamoto, Taku* O-34
Okawa, Hiroshi* O-29
Okudaira, Tomohiro P-47
Omura, Ayano* P-58
Osawa, Satoshi* P-28
Ota, Hidetoshi* O-06
Ota, Hiroshi* P-52
Ouchi, Yuki* P-01
Saka, Masahiro* O-14
Sakamoto, Mariko* O-28
Sarashina, Miho
Sasai, Takahide* P-39
Sato, Naoki*
Sato, Takanori* O-40
Sengoku, Showichi*
Shibata, Rintaro*
Shimada, Takahiro* P-02
Shimada, Tomohiko* O-39
Shintani, Nozomi* O-55
Sitomi, Yuko* O-09
Song, Jae-Young* P-07
Sugawara, Hirotaka O-27
Sumida, Masayuki* P-30
Suzuki, Dai* O-23
Suzuki, Daisuke O-33
Tada, Noriko* O-22
Tagami, Masataka* P-49
Takagi, Masanori
Takahashi, Akio* P-04
Takahashi, Hiroo* P-40
Takechi, Tomomi* P-42
Takeda, Masayoshi*
Takenaka, Sen* O-35
Takeuchi, Hirohiko* O-50
Takeuchi, Misato* O-21
Tanabe, Shingo*
Tanaka, Koji* O-17
Tandavanitj, Nontivich* O-53
Taniguchi, Mari* O-20
Tanimura, Narishige
Tatewaki, Kouji*
Tawa, Yuko* P-38
Tempaku, Makio P-13
Terui, Shigeharu P-59
Toda, Mamoru* O-08
Toda, Mitsuhiko* P-24
Toda, Setsuko*
Togane, Dai* P-17
Togashi, Tadashi
Tokuda, Tatsuhiro*
Tominaga, Atsushi* P-48
Tomioaka, Katsuhiko*
Tsuchikane, Satoko*
Ueda, Haruki O-12
Umemura, Keitaro
Wang, Bin* O-04
Watanabe, Kiyoshi*
Yabe, Takashi* P-12
Yagi, Ai* P-18
Yamada, Shoichi* O-13
Yamagami, Masafumi* P-50
Yamamoto, Yasuhito* P-26
Yashiro, Ayako*
Yasumori, Akifumi
Yoneshima, Ryo*
Yoshikawa, Akiko P-11
Yoshikawa, Natsuhiko* O-57
Yoshimura, Masako*
Yoshimura, Yuri* O-41